

DCLCD35 LCD Controller

Introduction

The DCLCD35 is a seven button controller with 3.5" colour LCD screen, designed to provide advanced control of lighting, blinds and other building automation functions.

The DCLCD35 features multiple control pages with five programmable keys that change their function depending on the displayed page. 'Home' and 'Next' keys provide additional navigation.

The DCLCD35 is ideally suited to conference rooms, meeting rooms, training facilities and foyers; where advanced control of lighting scenes is required.

Features

- 3.5" color TFT LCD screen
- Multi-page configuration
- Five programmable keys per page
- 'Home' and 'Next' keys
- Ability to control lights on any BM-DALI line
- Ethernet interface (RJ45).

Ordering Information

Part Number	Description
DCLCD35	DCLCD35 LCD Controller
DCLCD35WB	DCLCD35 Wallbox
8050P12/1600	Power Supply 12V d.c. 1.6A

Specifications

Controller

- Kernel 32 bit ARM9 low voltage 200MHz
- Built-in RTC and watchdog timer
- SDRAM: 64MB
- Flash: 128MB
- OS: Windows CE.

Display

- Data image 3.5" TFT LCD with 240 x 320 resolution.

Audio

- 1W speaker
- Audio line-out.

Power Supply (supplied separately)

- 12V d.c. 6W.

Mechanical Specifications

- Wallbox for installer (supplied separately)
- Plastic enclosure
- Weight 260g
- 1 Phoenix type connector for power
- 1 RJ45 type connector for Ethernet.

Environmental Specifications

- Operating temperature 0 ~ 40°C
- Relative humidity 10 ~ 95% @ 40°C (non-condensing)
- Safety UL, CUL, CE
- EMS CE Class B
- EMI FCC, CE Class B.



DCLCD35

System Dimensions (mm)

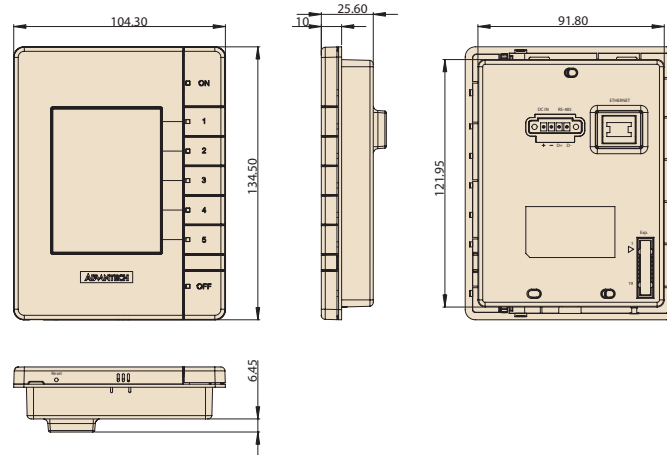

Wallbox Dimensions (mm)

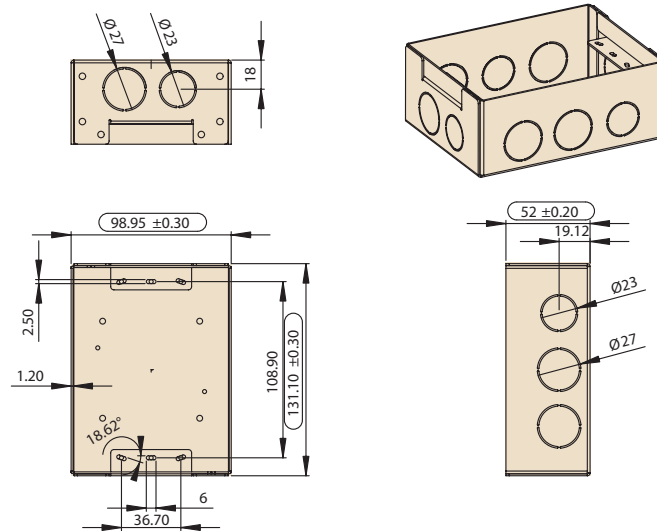

Clipsal Australia Pty Ltd

A member of Schneider Electric

Head Office

33-37 Port Wakefield Road,
Gepps Cross, South Australia 5094

Postal Address

PO Box 132
Enfield Plaza, South Australia 5085

Website www.dalicontrol.com

Contact your local Schneider Electric office for sales and technical support. www.clipsal.com/trade/contact_us

You can find this data sheet and many others online in PDF format at:
www.dalicontrol.com

clipsal.com

Clipsal Australia Pty Ltd reserves the right to change specifications, modify designs and discontinue items without incurring obligation and whilst every effort is made to ensure that descriptions, specifications and other information in this catalogue are correct, no warranty is given in respect thereof and the company shall not be liable for any error therein.

© Clipsal Australia Pty Ltd

This material is copyright under Australian and international laws. Except as permitted under the relevant law, no part of this work may be reproduced by any process without prior written permission of and acknowledgement to Clipsal Australia Pty Ltd.